

LINCOLN COUNTY

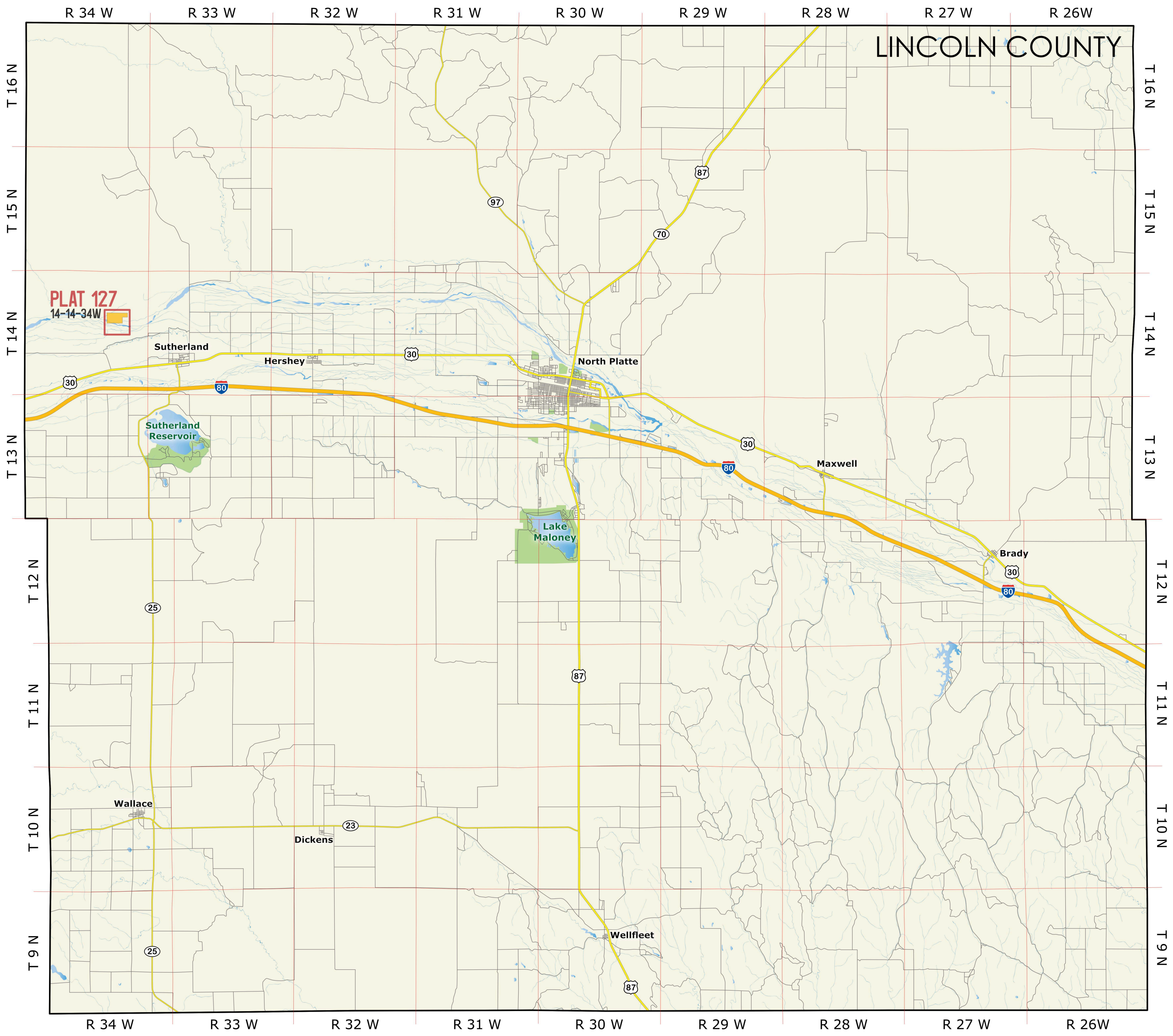

PLAT 127
14-14-34W

Sutherland

Hershey

North Platte

Sutherland Reservoir

Lake Maloney

Maxwell

Brady

Wallace

Dickens

Wellfleet

R 34 W

R 33 W

R 32 W

R 31 W

R 30 W

R 29 W

R 28 W

R 27 W

R 26W

T 16 N

T 15 N

T 14 N

T 13 N

T 12 N

T 11 N

T 10 N

T 9 N

T 16 N

T 15 N

T 14 N

T 13 N

T 12 N

T 11 N

T 10 N

T 9 N

R 34 W

R 33 W

R 32 W

R 31 W

R 30 W

R 29 W

R 28 W

R 27 W

R 26W

STIPULATIONS (SPECIAL LEASE PROVISIONS) FOR LINCOLN #127:

The Board may terminate this Lease, in whole or in part, prior to its scheduled expiration date by 1) giving at least nine (9) months' notice of termination to the Lessee, or 2) giving written notice of termination to the Lessee stating that the lease shall terminate on December 31st of the year notice was given. In the event of such early termination, any bonus paid for this Lease will be partially refunded. The unused percentage of the original lease term shall be multiplied by the bonus previously paid to determine the refund amount.

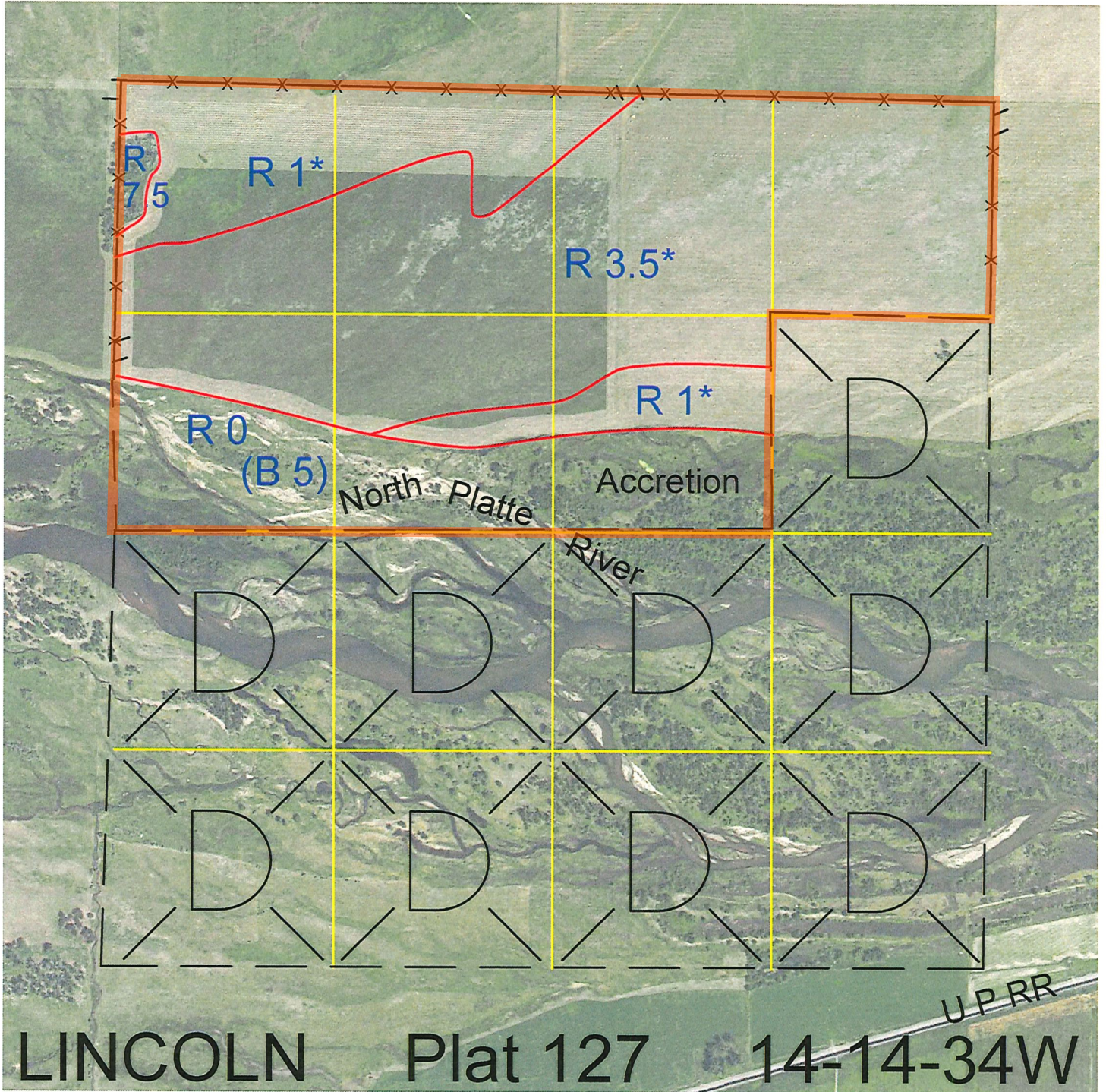

<u>Legal</u>	<u>Lease #</u>	<u>Expiration</u>	<u>Acres</u>
The N2N2 and Government Lots 2, 3 and 4 and all accretions thereto	111698-23	12/31/2023	243.60

Total Section Acres 243.60

Location: 2 miles north and 3 miles west of Sutherland, NE.

Best Access: From the north.

Land Classification Codes:

>D< indicates land not owned by the School Land Trust

- | | | | |
|---|---|----|--|
| A | Dryland Cropland | M | Pivot Irrigated Cropland (Trust owned well) |
| B | Special Land Class | NU | Non-Utility (No Value) |
| C | Water for Livestock | P | Pivot Irrigated Cropland (Lessee owned well) |
| E | Enhanced Value | R | Grassland (Typical Rent) |
| F | Gravity Irrigated Cropland (Trust owned well) | S | Grassland (Lower Rent than R Classification) |
| G | Grassland (Higher Rent than R classification) | T | Real Estate Tax Recapture |
| H | Non-Agricultural Land Class | W | Gravity Irrigated Cropland (Lessee owned well) |
| I | Canal Irrigated Cropland | | |

For further information, please call Field Representative: Justin Lemmer at (308) 221-6249.

Plat # 127