

HOLT COUNTY

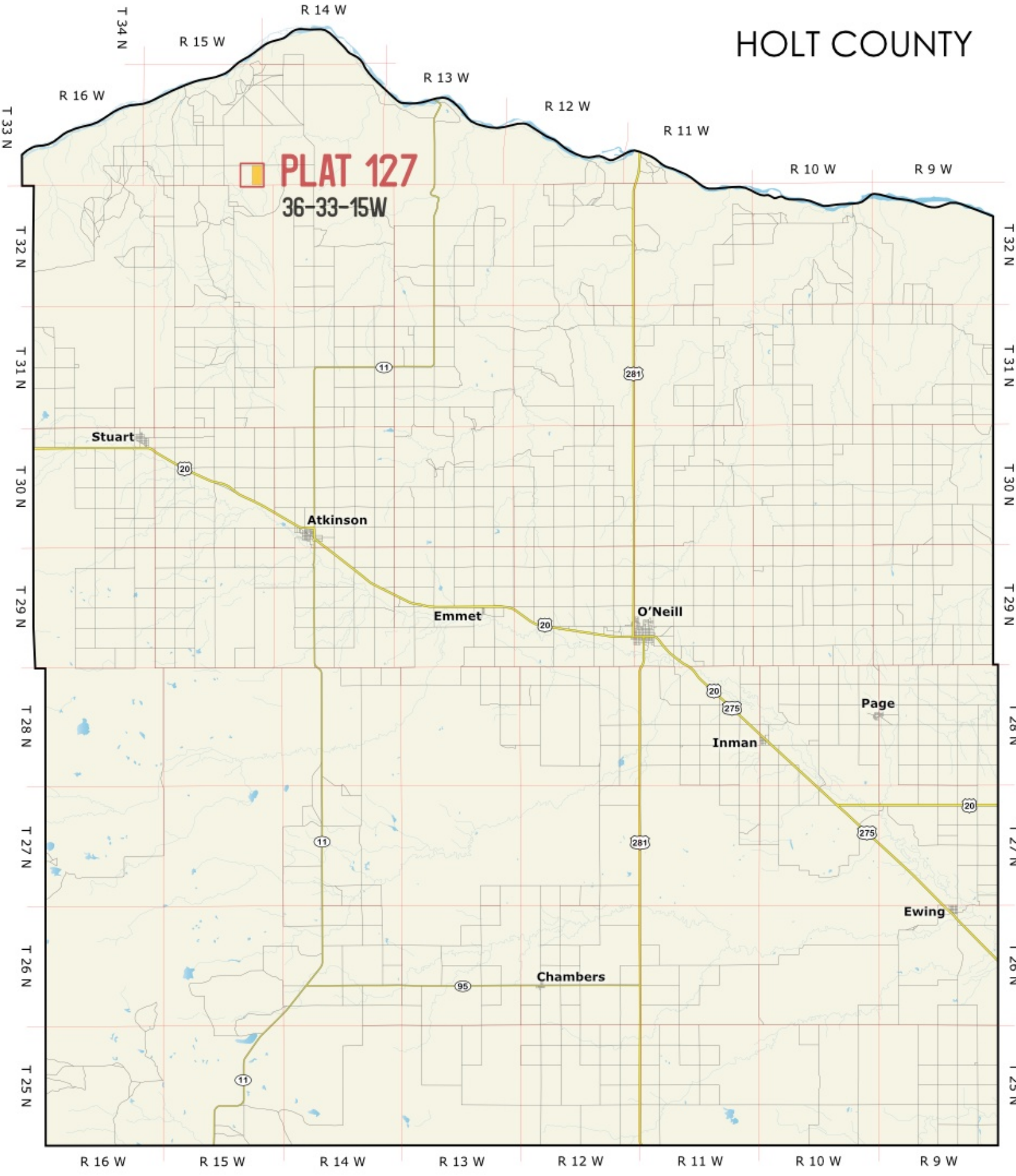

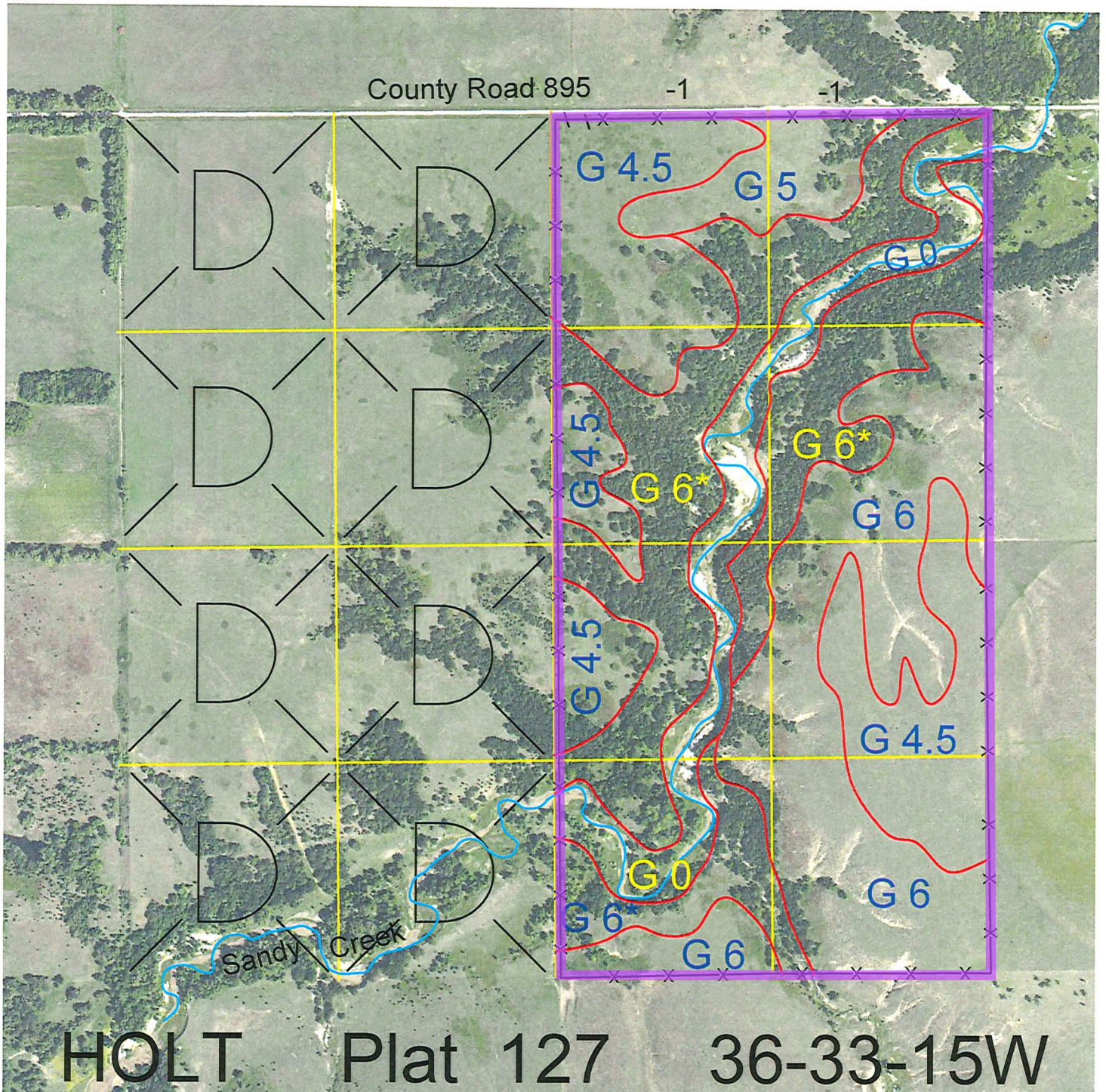

<u>Legal</u>	<u>Lease #</u>	<u>Expiration</u>	<u>Acres</u>
E2	112752-24	12/31/2024	320

Total Section Acres **320**

Location: Approximately 18 miles north and 2.5 miles west of Atkinson, NE.

Best Access: County Road #895 on the north.

Land Classification Codes: >D< indicates land not owned by the School Land Trust

- | | | | |
|---|--|----|---|
| A | Dryland Croppground | M | Pivot Irrigated Croppground (Trust owned well) |
| B | Special Land Class | NU | Non-Utility (No Value) |
| C | Water for Livestock | P | Pivot Irrigated Croppground (Lessee owned well) |
| E | Enhanced Value | R | Grassland (Typical Rent) |
| F | Gravity Irrigated Croppground (Trust owned well) | S | Grassland (Lower Rent than R Classification) |
| G | Grassland (Higher Rent than R classification) | T | Real Estate Tax Recapture |
| H | Non-Agricultural Land Class | W | Gravity Irrigated Croppground (Lessee owned well) |
| I | Canal Irrigated Croppground | | |

For further information, please call Field Representative: Tad Judge at (402) 340-6744.

Plat # 127